

alu

A better seat

Alutech 300 / 400
Series and OP 300
User Manual

alu
A better seat

© Alu Design & Services AS | Skibåsen 44, Norway, 4636 Kristiansand

T: +47 46 82 60 00 | info@alu-design.no

www.alu-design.no

USER MANUAL ALUTECH 300 / 400 SERIES AND OP 300

ARMREST ADJUSTMENT

Flip the armrest backwards if more space is required.

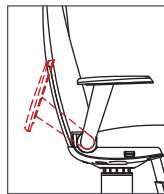

LUMBAR SUPPORT

Use the pump mechanism to adjust the lumbar support. The pump can be easily reached when user is seated.

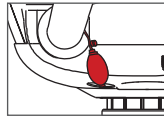

DECKRAIL MOVEMENT

Lift the lever gently to release the break from the deckrail.
Please ensure to push the lever back to lock the seat into position.
The chair should always be locked on the rail to avoid injury.

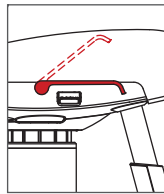

BACKREST ADJUSTMENT

Lift the lever gently onto recline the seat into the desired position. The maximum reclining angle varies, depending on the type of Alutech 500 delivered.



MANUALS / TOOLKIT

Toolkit, installation and user manuals are inserted under the footrest and included for each chair delivered.

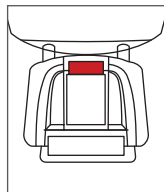

LOGO

Option to have customer logo stitched to the back or front of the chair seats.

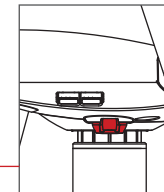

CHAIR ROTATION

Push lever forward to rotate the seat. It is recommended to lock the seat in the desired position by firmly pulling the lever backwards until the chair is fixed.

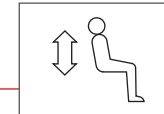

HEIGHT ADJUSTMENT

Lift the lever gently to adjust the sitting height of the chair. The function is operated by gas struts, so please leave the chair when raising the height, but remain seated when lowering the height.

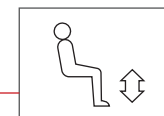

FOOTREST ADJUSTMENT

Lift the lever gently and press footrest down to extend space for legs or let the gas strut lift it into the desired position.

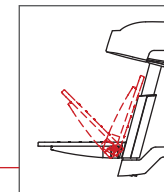

Manually rotate the footrest up and down.

For more detailed information please refer to installation and user manuals that follow every chair delivered.
Please maintain the seat upholstery with mild detergents or as recommended.